

REVISIONS	
17/04/13	A Layout, Elevations amended
03/07/13	B Staircase amended
12/07/13	C Plinth walls to kitchen amended
24/07/13	D Study removed, windows added to living room
13/08/13	E Main flue arrangement amended
05/09/13	F Wall removed, window added to Master, velux added to Bed 4



SOUTH WEST ELEVATION

SOUTH EAST ELEVATION

NORTH EAST ELEVATION

NORTH WEST ELEVATION

LEGEND

- Soil and Vent Pipe Position
- Soil and Vent Pipe Position Boxed as Detail
- Soil and Vent Pipe with Air Admittance Valve
- Soil and Vent Pipe with Air Admittance Valve boxed as detail
- Rainwater Down Pipe Position
- Smoke detector position
- Denotes specialist means of escape window
- Individual back ground ventilator within frame - Tilon Trimvent reference XS16 vent with XC16 canopy - 4500mm² each
- New boiler to specification in accordance with SAP assessment
- Mechanical extract through wall
- Mechanical extract through ceiling
- Whole house ventilation unit. Type to be in accordance with SAP assessment. Unit to have condensate pipe falling to drain via trap. To be installed to specialist's design and details
- S1 - Supply warm
- S2 - Supply cold
- E1 - Extract from wet areas
- E2 - Extract to outside
- W1 - 15mm dia. Condensate to drain
- Whole house ventilation with heat recovery supply outlet. Grille design, type and colour to be confirmed.
- Whole house ventilation with heat recovery extract grille. Grille design, type and colour to be confirmed.
- 204x60mm rectangular section ductwork for whole house ventilation system
- 204x60mm rectangular section supply and extract ductwork
- 125mm circular section supply and extract ductwork
- 204x60mm rectangular ducting 90° bend
- 204x60mm rectangular ducting T-piece
- Electrical meter cabinet - recessed
- Gas meter cabinet - recessed
- Gas meter cabinet - Ground box
- Water service inlet position
- Telecom service inlet position
- Balanced flue boiler terminal - elevation
- Electrical meter cabinet - recessed - elevation
- Gas meter cabinet - recessed - elevation
- Gas meter cabinet - ground box - elevation
- Mechanical extract terminal - elevation
- Movement joint as spec
- Position of structural beam over
- Direction of joist span over
- Outline of foundation
- Notional air barrier
- Section Line Position - ID and related drawing number

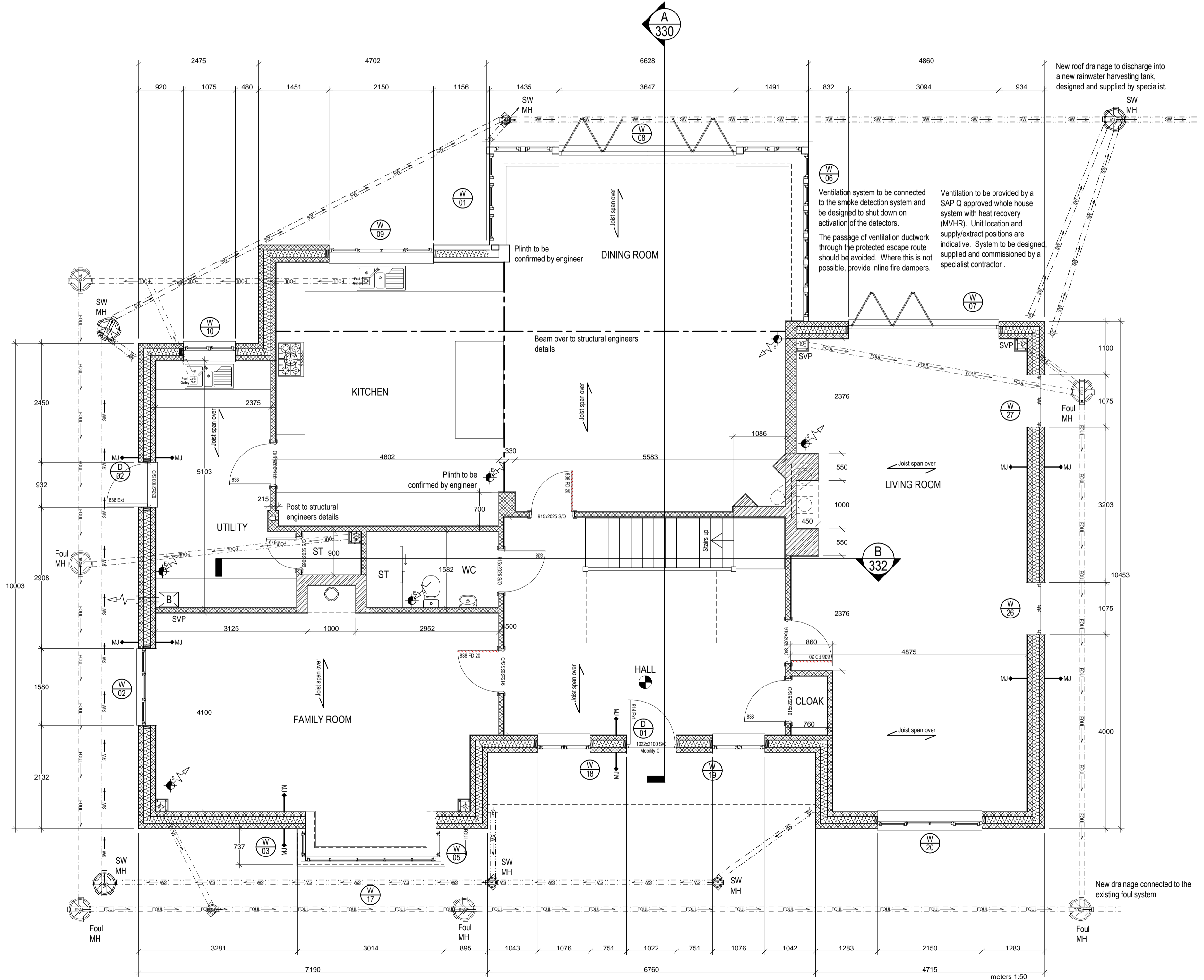

New roof drainage to discharge into a new rainwater harvesting tank, designed and supplied by specialist.

Ventilation system to be connected to the smoke detection system and be designed to shut down on activation of the detectors. The passage of ventilation ductwork through the protected escape route should be avoided. Where this is not possible, provide inline fire dampers.

Ventilation to be provided by a SAP Q approved whole house system with heat recovery (MVHR). Unit location and supply/extract positions are indicative. System to be designed, supplied and commissioned by a specialist contractor.

Bell Street Studios
Bell Street, Sawbridgeworth
Hertfordshire
CM21 9AN
T: 01279 600110
F: 01279 722004
enquiries@brdtech.co.uk
www.brdtech.co.uk

SUSTAINABLE ARCHITECTURE

PLOT 3
SITE ADJACENT WHITEHALL LEYS
WHITEHALL ROAD,
BISHOPS STORTFORD.

PROPOSED
GROUND FLOOR PLAN
AND ELEVATIONS

Scale: 1:50, 1:100 Date: **APRIL 13** Drawn By: **PD**
Ref: **BRD/13/009/131** Rev: **F**



This drawing and design remain the property of BRD TECH LTD and should not be reproduced or altered in any way without their consent. All dimensions, levels and information indicated is to be verified on site prior to the commencement of any work on site. Any discrepancies are to be reported to BRD TECH LTD directly.